

Missouri State Medical Association
165th ANNUAL CONVENTION



**OFFICIAL
PROGRAM**

March 31 - April 2, 2023
Westin Kansas City at Crown Center
Kansas City, Missouri



OFFICIAL PROGRAM TABLE OF CONTENTS

Annual Convention General Information 2
CME Procedures and Information..... 4
House of Delegates Agendas..... 5
MSMA Convention Schedule..... 6
MSMA General Sessions 11
Hotel Maps..... 16

165th Annual Convention Sponsors



Westin Kansas City at Crown Center

1 East Pershing Road • Kansas City, MO 64108 • Tel: 816-474-4400

Annual Convention General Information

On-Site Registration

Registration for the House of Delegates is in the Century Foyer and open from 3:00 to 6:00 p.m. on Friday, March 31, and 6:30 a.m. to 5:00 p.m. on Saturday, April 1. **There is no registration on Sunday, April 2.**

House of Delegates

The 165th Session of the MSMA House of Delegates will convene at 8:30 a.m. on Saturday, April 1, and conclude around 9:30 a.m. It will consist of reports, awards, speeches, and consideration of acceptance of late resolutions. On Sunday, April 2, the House will convene at 8:15 a.m. to hear the report from the Reference Committee and install officers.

Delegates **MUST** register at the MSMA Registration Desk and identify themselves as a Delegate to obtain the Delegate's credentials and badge. Delegates are included on a list at the MSMA Registration Desk. Delegates are urged to register early so that they may be seated promptly when the House is called to order.

NOTE: Delegates MUST register for the meeting prior to 5:00 p.m. on Saturday, April 1. After 5:00 p.m. on Saturday, April 1, registration is closed. There is no registration on Sunday, April 2.

Resolutions

Resolutions submitted after the February 15 deadline are considered late resolutions. For resolutions submitted after 8:30 a.m. on Friday, March 31, the individual or society introducing a late resolution must supply sufficient copies, printed in standardized format, for the entire House of Delegates at its opening session (plus 10 copies delivered to the MSMA Secretary at the time of its introduction). Late resolutions will be accepted as business of the House, but those that miss the March 31 deadline will be referred to the Reference Committee only if approved by two-thirds of the Delegates voting.

All members of the MSMA are privileged and urged to attend the House of Delegates and the meeting of the Reference Committee. While discussion and voting in the House is limited to Delegates, any Association member may present his or her viewpoint during the meeting of Reference Committee when recognized by the Chair.

Reference Committee

The Reference Committee will begin at 9:30 a.m. on Saturday, April 1.

Proceedings

Proceedings of the House of Delegates are conducted in accordance with *Sturgis Standard Code of Parliamentary Procedure*.

Open Attendance Policy

The MSMA Annual Convention offers an “Open Attendance Policy” to all Convention attendees. Exceptions are food programs, which are members- or reservations-only, and closed board/business meetings.

Appropriate Attire

Appropriate attire for the Convention is business casual for all sessions and events, except the Presidential Inauguration and Reception on Saturday evening, which calls for Black Tie Optional or Business Formal.

Communication Devices

Please turn all communication devices to “silent” during meetings.

MSMA Staff Headquarters

MSMA Staff is headquartered in the Presidents room.

Meeting, Location, and Time Assignments

All room and time assignments are listed in this Convention Official Program. Any changes to the schedule are available at the MSMA Registration Desk.

Online Post-Convention Survey

Attendees are invited to evaluate the Convention via an online survey which will be emailed to you.

WI-FI Network: WESTIN-MEETING
WI-FI Password: MSMA2023

CME Information

CME Procedures

The Missouri State Medical Association is accredited by the Accreditation Council for Continuing Medical Education to provide continuing medical education for physicians. The Missouri State Medical Association designates this live activity for a maximum of **4.0 AMA PRA Category 1 Credits™**. Physicians should only claim credit commensurate with the extent of their participation in the activity.

Evaluation Forms - How to Obtain CME Credit

- In order to receive CME credit for attending scientific sessions, participants **MUST** complete and return the evaluation forms passed out at each scientific session.
- Give the completed evaluation to the moderator of the session you attended.
- MSMA members earn their CME for free.
- After all evaluations are processed at MSMA Headquarters, you will be emailed your CME certificate in eight to ten weeks.
- Make sure your contact/email information is **LEGIBLE**.

Disclosures: Commission on Continuing Education

The MSMA Commission on Continuing Education serves as the planning committee for the Annual Convention.

- Inderjit Singh, MD, St. Louis, Chair
- Peggy Barjenbruch, MD, Mexico
- Jamie Lawless, MD, Kansas City
- Purvi Parikh, MD, Hannibal
- Joan Shaffer, MD, Webster Groves
- Hamsa Subramanian, MD, St. Louis
- Douglas Wallace, MD, Lakewood, WA
- Council Advisor: Louis DelCampo, MD, Springfield

House of Delegates

Agendas

Opening Session

Saturday, April 1 • 8:30 am • Century C - Ballroom Level

- Call to Order – Timothy Swearingin, DO, Speaker
- Pledge of Allegiance – Timothy Swearingin, DO
- Housekeeping Items – Timothy Swearingin, DO
- Report of the Committee on Credentials – Joseph Corrado, MD
- Approval of Minutes of 2022 Meeting – Timothy Swearingin, DO
(Published in *Missouri Medicine*, May/June 2022)
- Speaker's Instructions /Appointment of Reference Committee – Timothy Swearingin, DO
- President's Message – George Hubbell, MD
- Report of the President of the MSMA Alliance – Sana Saleh
- Presentation of Award – George Hubbell, MD
- Appointment of the Committee on Nominations – George Hubbell, MD
- Late Resolutions – Timothy Swearingin, DO
- New Business – Timothy Swearingin, DO

Second Session

Sunday, April 2 • 8:15 am • Century C - Ballroom Level

- Call to Order – Laurin Council, MD, Vice Speaker
- Housekeeping Items – Laurin Council, MD
- Report of the Committee on Credentials – Joseph Corrado, MD
- Report of the Nominating Committee – Sarah Florio, MD
- Election of the President Elect – Timothy Swearingin, DO
- Appointment to the Council on Ethical and Judicial Affairs – Lancer Gates, DO
- Report of the Election of Councilors – Ellen Nichols, MD
- Report of the Reference Committee – Carlin Ridpath, MD
- New Business – Timothy Swearingin, DO

Annual Convention Schedule of Events

Pre-Convention Meetings Friday, March 31

1:00-2:00 pm	MSMA Insurance Agency Board Meeting <i>The Boardroom – Executive Office Level</i>
2:00-4:00 pm	MSMA Executive Committee Board Meeting <i>The Boardroom – Executive Office Level</i>
3:00-6:00 pm	MSMA Convention Registration <i>Century Foyer – Ballroom Level</i>
3:30-5:30 pm	Alliance Past Presidents Reception <i>Mission – Ballroom Level</i>
4:15-5:15 pm	CME: “Health Equity Opportunities for Doctors and State Medical Associations” MSMA General Session <i>Century C – Ballroom Level</i>
5:30-7:00 pm	MSMA Convention Opening Reception Hors d’oeuvres & Cash Bar <i>Century A – Ballroom Level</i>
7:00-8:00 pm	Women Physicians Section/Young Physician Section Mixer <i>1 East Restaurant & Bar – Lobby Level</i>
7:00-8:30 pm	MSMA Medical Student Section Meeting <i>Roanoke – Ballroom Level</i>

Convention Meetings

Saturday, April 1

- 6:30 am-5:00 pm **MSMA Convention Registration**
Century Foyer – Ballroom Level
- 6:30-7:30 am **MSMA International Medical Graduate Section**
Business Meeting
The Boardroom – Executive Office Level
- 6:30-7:30 am **MSMA Medical Student Section**
Business Meeting
Penn Valley – Ballroom Level
- 6:30-7:30 am **MSMA Young Physician Section**
Business Meeting
Roanoke – Ballroom Level
- 7:30-8:30 am **Moneta Financial Group**
Product Theater Breakfast
(Free with registration)
Century A – Ballroom Level
- 7:00 am **Alliance Annual Meeting**
Registration & Information
Pershing Place North/South – Ballroom Level
- 8:30-9:30 am **MSMA House of Delegates**
Opening Session
Century C – Ballroom Level
- 9:30-10:15 am **Alliance Annual Meeting**
Business Meeting
Pershing Place North/South – Ballroom Level
- 9:30-11:30 am **MSMA Reference Committee**
Liberty

- 9:30-11:30 pm **Missouri Physicians Health Program**
Board Meeting
The Boardroom – Executive Office Level
- 10:30-11:45 am **Alliance Program**
**“Limitations of Public School Interventions for Students
with Learning Disabilities”**
Pershing Place North/South – Ballroom Level
- 11:00 am-Noon **Kansas City Medical Society**
Caucus
Westport – Ballroom Level
- 11:00 am-Noon **St. Louis Metropolitan Medical Society**
Caucus
Roanoke – Ballroom Level
- 11:30 am-12:30 pm **Networking Lunch**
(Free with registration)
Century A – Ballroom Level
- Noon-1:45 pm **Alliance**
Spirit of the Alliance Recognition Lunch
& Memorial Service
Mission – Ballroom Level
- 12:45-1:45 pm **CME: “The Opioid Epidemic: Striving to Provide
Holistic Care to Patients Who Use Drugs”**
MSMA General Session
Century C – Ballroom Level
- 2:00-3:00 pm **Alliance Program**
“Hope on the Horizon”
Pershing Place North/South – Ballroom Level
- 2:00-3:00 pm **CME: “Environmental Health:
An Overview for Missouri Physicians”**
MSMA General Session
Century C – Ballroom Level

- 2:00-3:00 pm **Missouri State Medical Foundation**
Board Meeting
The Boardroom – Executive Office Level
- 3:00-4:00 pm **Missouri Medical Political Action Committee**
Board Meeting
Shawnee – Ballroom Level
- 3:15 pm **Alliance**
Installation of 2023-2024 Officers
Pershing Place North/South – Ballroom Level

Board Meeting
Pershing Place North/South – Ballroom Level
- 3:15-4:15 pm **CME: “Marijuana/Cannabis Guidance for Medical Providers: Follow the Science”**
MSMA General Session
Century C – Ballroom Level
- 4:30-5:30 pm **Women Physicians Section**
Business Meeting
Westport – Ballroom Level
- 4:30-6:30 pm **Medical School Receptions**
Saint Louis University
Roanoke – Ballroom Level
- 4:30-6:30 pm University of Missouri – Columbia
Pershing Place West – Ballroom Level
- 4:30-6:30 pm University of Missouri – Kansas City
Pershing Place East – Ballroom Level
- 5:15-6:15 pm **Reception**
50-Year Pin Recipients
MSMA & MSMA Alliance Past Presidents
MMPAC Diamond Club Members
Mission – Ballroom Level

- 6:00 pm **Seating Opens for MSMA Presidential Inauguration**
Liberty – Ballroom Level
- 6:30-7:30 pm **MSMA Presidential Inauguration**
Liberty – Ballroom Level
- 7:30 pm **MSMA Presidential Reception**
Hors d’oeuvres & Cash Bar
Century AB – Ballroom Level

Convention Meetings Sunday, April 2

- 7:00-8:00 am **District Breakfasts & Caucuses**
All rooms on Ballroom Level

- Breakfast Buffet – *Roanoke Foyer*
- Additional Breakfast Seating – *Pershing Place East*
- District #1 – *Roanoke*
- District #2 – *Roanoke*
- District #3 – *Mission*
- District #4 – *Liberty*
- District #5 – *Liberty*
- District #6 – *Pershing Place West*
- District #7 – *Pershing Place North*
- District #8 – *Penn Valley*
- District #9 – *Pershing Place West*
- District #10 – *Westport*
- MSS/IMG Caucuses – *Pershing Place South*
- WPS/YPS/RFS Caucuses – *Shawnee*

- 8:15 am **MSMA House of Delegates**
Second Session
Century C – Ballroom Level

- Immediately
Following HOD **MSMA Council**
Meeting
Century B – Ballroom Level

MSMA General Session

Friday, March 31 • 4:15 pm • Century C - Ballroom Level



Health Equity Opportunities for Doctors and State Medical Associations

Speaker

*William Jordan, MD, MPH
Health Equity Policy Director
American Medical Association
Chicago, Illinois*

Objectives

1. Define health equity using a metaphor.
2. Describe a state or national example of a medical association advancing health equity.
3. Identify an opportunity for individual physicians to advance health equity through their medical association.

Moderator

Lancer Gates, DO

CME

1.0 AMA PRA Category 1 Credits™

CME

MSMA General Session

Saturday, April 1 • 12:45 pm • Century C - Ballroom Level



The Opioid Epidemic: Striving to Provide Holistic Care to Patients Who Use Drugs

Speaker

Nathan Nolan, MD, MPH, MHPE

Instructor of Medicine - Infectious Disease

St. Louis VA and Washington University School of Medicine

St. Louis, Missouri

Objectives

1. Articulate the importance of caring for patients who use drugs (PWUD).
2. Develop a fundamental harm reduction approach to PWUD.
3. Describe appropriate steps in management of addiction and comorbid conditions in PWUD.

Moderator

David Pohl, MD

CME

1.0 AMA PRA Category 1 Credits™

MSMA General Session

Saturday, April 1 • 2:00 pm • Century C - Ballroom Level



Environmental Health: An Overview for Missouri Physicians

Speaker

*Elizabeth Friedman, MD, MPH
Region 7 (Missouri, Kansas, Nebraska, Iowa) Mid America-Pediatric
Environmental Health Specialty Unit Director
Medical Director, Environmental Health Program
Children's Mercy Hospital, Kansas City, Missouri
Assistant Professor Pediatrics, University of Missouri - Kansas City
School of Medicine*

CME

Objectives

1. Examine basic insight into how the field of environmental health has developed.
2. Describe basic physiological and behavioral differences that make individuals more vulnerable to toxic exposures during certain life stages.
3. Discuss environmental exposures and routes of absorption, metabolism, and distribution, and recognize the health effects of environmental toxicants.
4. Explain how ongoing epidemiological and toxicological studies have altered our concept of what is “acceptable” exposure.
5. Recognize anthropogenic sources of environmental contamination and how they affect human health.

Moderator

George H. Hubbell, MD

CME

1.0 AMA PRA Category 1 Credits™

CME Programs
continued next page

MSMA General Session

Saturday, April 1 • 3:15 pm • Century C - Ballroom Level



Marijuana/Cannabis Guidance for Medical Providers: Follow the Science

Speaker

Roneet Lev, MD, FACEP

Executive Director of Independent Emergency Physician Consortium; Chair of the San Diego Community Response to Drug Overdose Task Force; Former Chief Medical Officer of the White House Office of National Drug Control Policy 2018-2020; Former Chief of Scripps Mercy Hospital/San Diego Emergency Department; Founder and Vice President of IASIC, the International Academy on the Science and Impact of Cannabis

Objectives

1. Recognize cannabis-related medical conditions.
2. Discuss drug interactions with cannabis products.
3. Explain how to include cannabis-related diagnosis in medical documentation.

Moderator

Brian Biggers, MD

CME

1.0 AMA PRA Category 1 Credits™

MoDocs®



*Giving Missouri Doctors
the Peace of Mind to do
What Doctors do Best®*



SCAN TO SUBMIT A
REQUEST FOR A QUOTE

MISSOURI DOCTORS MUTUAL INSURANCE COMPANY • 601 FRANCIS STREET ST. JOSEPH, MO 64501
www.modocs.org • 800.264.5959

Westin Kansas City at Crown Center Floor Maps

Lobby Level

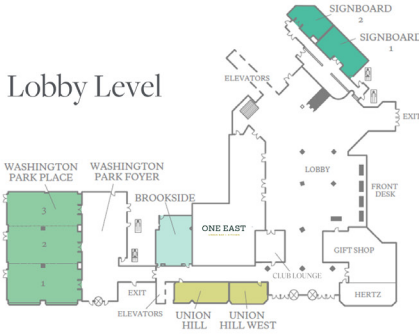

Ballroom Level

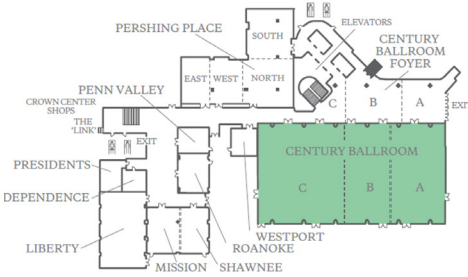

Executive Office Level



5th Floor Meeting Rooms

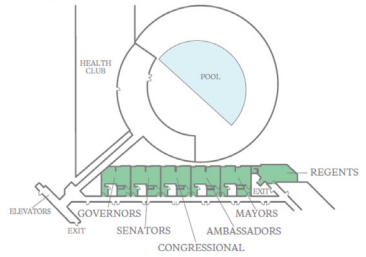

20th Floor Benton's

